



Cloud Connector

imageRUNNER
ADVANCE DX

imagePRESS Lite



**CLOUD
CONNECTOR**
A Convenient
Connection in
the Cloud

Pair Supported Canon MFPs to Select Cloud Services for Virtually Seamless Print and Scan Capabilities

Connecting to cloud services in the workplace is often a major contributor to overall efficiency. Cloud Connector from Canon is an easy-to-use application that connects imageRUNNER ADVANCE DX, imagePRESS Lite, and supported imagePRESS models¹ with select cloud services², allowing users to expand their print and scan capabilities without the need for additional backend system configuration. This convenient solution includes simple setup and activation steps, and an uncomplicated, do-it-yourself user registration process.

There are Cloud Connector options that enable users to easily:

Connect to select cloud services



Scan and upload directly
to cloud storage



Print from the cloud
at the device



Scan to email without
admin set up



Print from email without
use of print drivers

Connect Your Canon MFP to These Cloud Services with Cloud Connector

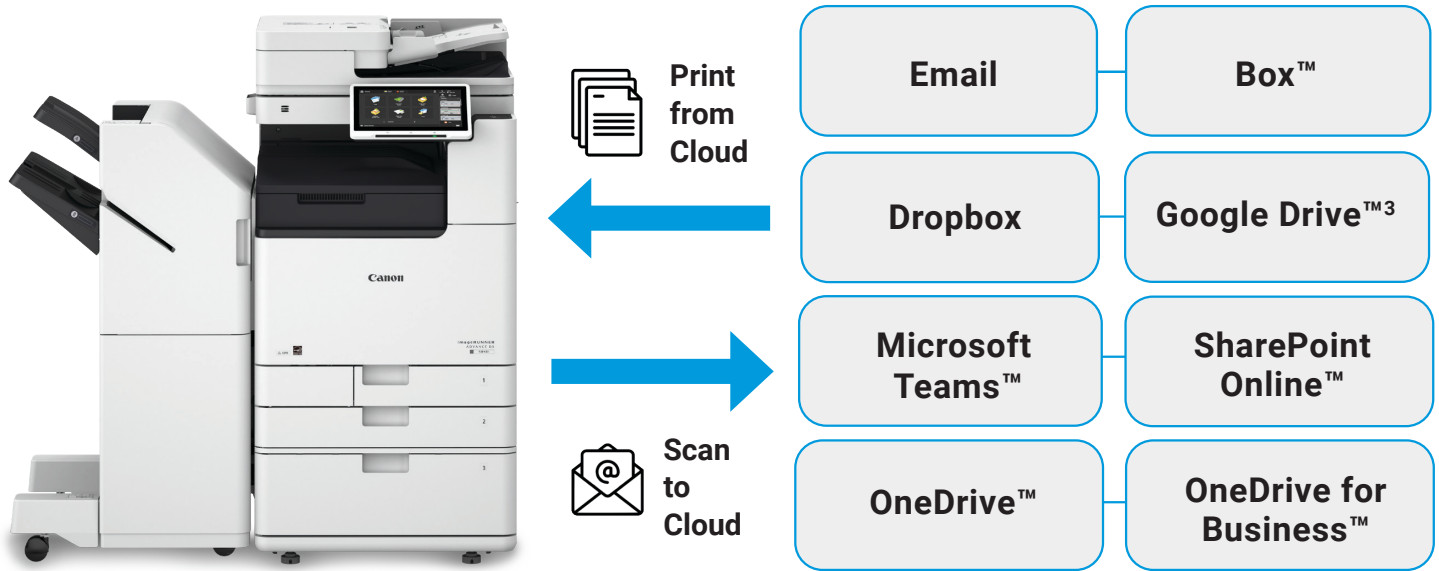

Note: One 3-year or 5-year term license required per destination per device. Each term license sold separately.

Once activated, users can single-handedly register for Cloud Connector without additional assistance from a Systems Engineer or Administrator.

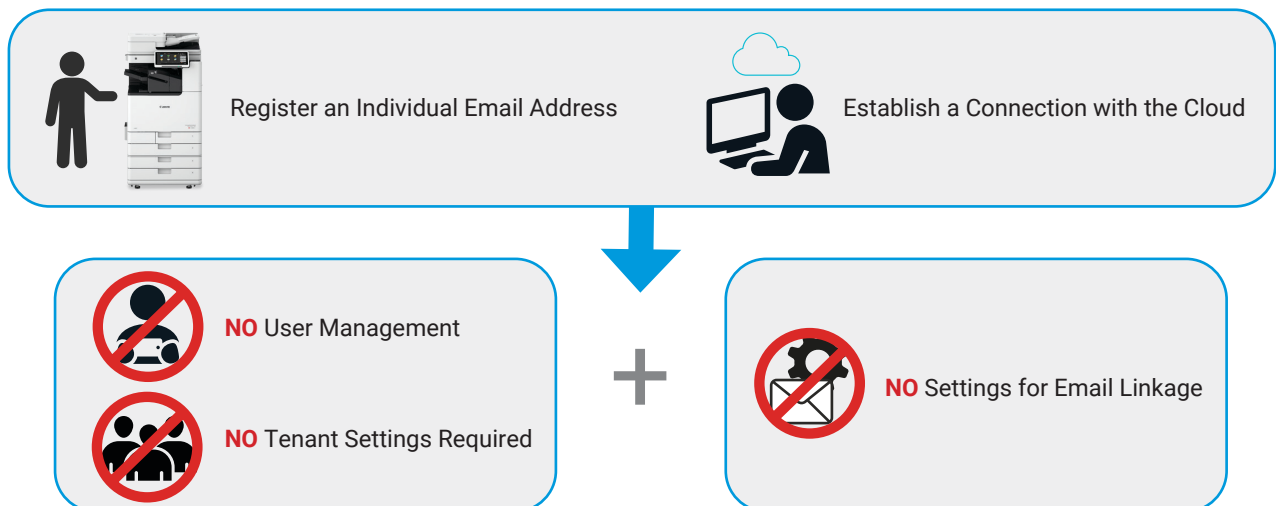

Experience Cloud Connector at Work

Simple User Registration Steps

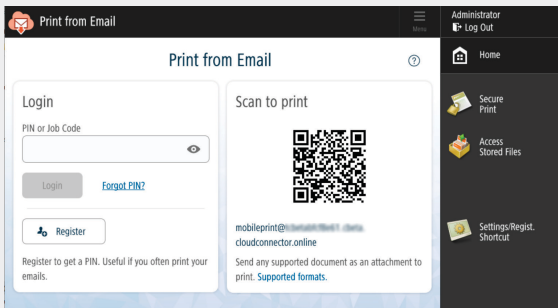

Select Register Button

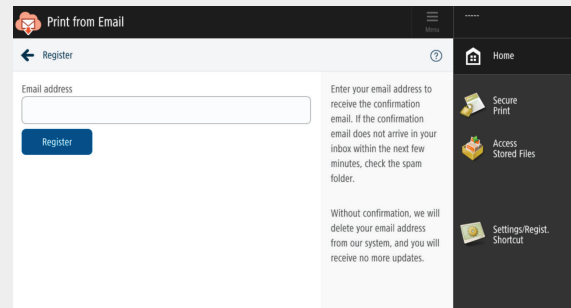

Enter Individual Email Address

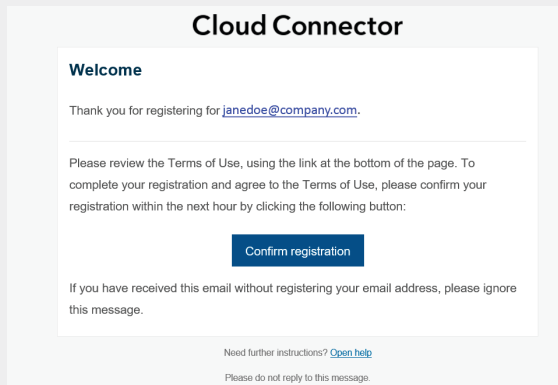

Select Confirm Registration on Email Received

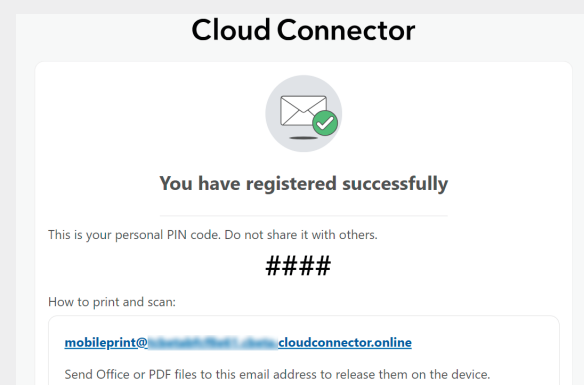

An Automatically Generated Pin Will Be Sent

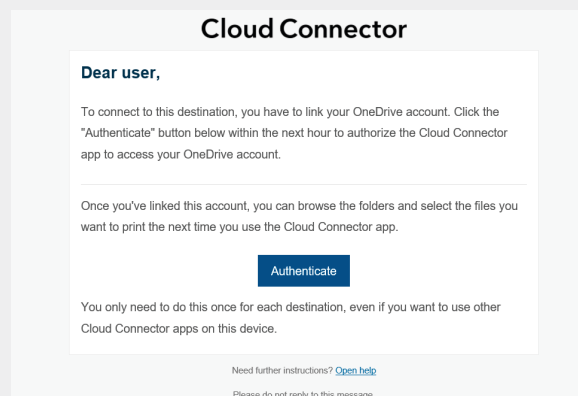
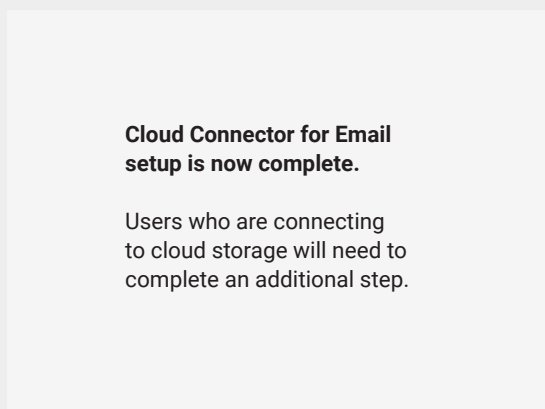

Authenticate to Cloud Service

Note: If you do not log in to Cloud Connector within 30 days, you will need to re-register with the device.

SPECIFICATIONS

Print Specifications

Functionality

Print compatible files from email or cloud storage

Supported Cloud Services

Box, Dropbox, Google Drive,³ OneDrive, OneDrive for Business, SharePoint Online, Microsoft Teams

Supported File Formats

PDF, HTML, XML, RTF, XLSX, DOCX, PPTX, WPD, BMP, GIF, ICO, JP2, JPG, PNG, TIFF (GoogleDrive³ only) Google document, Google spreadsheet, Google slide

Supported Paper Sizes

A4 (Outside the U.S.), LTR (U.S.)

File Size Limit

100 MB* Including attachments (Email), 30 MB (Cloud)

Number of Copies

1-9999

Color Options

Color, **Black/White**

Duplex Options

Simplex, **Duplex long edge**, Duplex short edge

Staple Options⁴

No Stapling, Single Staple/Eco Staple (Upper left, Lower left, Upper right, Lower right), Double Staple (Left, Top), Saddle Stitch Stapling

Scan Specifications

Functionality

Store the scanned document in the target cloud service or send it as an email attachment

Supported File Formats

TIFF, **PDF**, PDF (Compact), PDF/A

*PDF, PDF (Compact), and PDF/A become searchable PDF (with OCR text)⁵

Color Options

Automatic, Color, Grayscale, Black-and-white

Scan Resolutions (dpi)

TIFF: 100 x 100/150 x 150/200 x 100/200 x 200/200 x 400/**300 x 300**

PDF: **300 x 300**/600 x 600

PDF (Compact): **300 x 300**

PDF/A: **300 x 300**/600 x 600

Image Options

Text, Image, **Text/Image**, Photo, Map, Text/Photo/Map

Image options depend on model

Duplex Options

Simplex, Duplex long edge, Duplex short edge

File Naming Options

Enter up to 255 characters. All characters are allowed except: \ / : * ? " < > |

Default: Scan_ (Email address up to @ sign) _ (Current year -4 digits) (Current month){Current day}

Duplicate File Name Options⁶

Add a unique number, Abort, Overwrite

Density

0~10

Default: **5**

Scan Size Options

Auto, Manual, Different Size Originals

Supported Cloud Services

Box, Dropbox, Google Drive³, OneDrive, OneDrive for Business, SharePoint Online, Microsoft Teams

Email Attachment Limit

20 MB

* Blue = default value

¹ Cloud Connector is available for third-generation imageRUNNER ADVANCE, imageRUNNER ADVANCE DX, imagePRESS Lite, and the following imagePRESS models: imagePRESS V900, imagePRESS V800, imagePRESS V700.

² Subscription to a third-party cloud service required. Subject to third-party cloud service providers' terms and conditions. Neither Canon Inc. nor Canon Canada Inc. represents or warrant any third-party product or feature referenced hereunder.

³ Currently scheduled to be available in Q4 2023.

⁴ Stapling options vary depending on finisher capabilities.

⁵ If there is no license for searchable PDF, it does not come with OCR text.

⁶ If versioning in lists or libraries in SharePoint Online and OneDrive for Business is enabled, the settings configured at the device will not work.

Cloud Connector is supported by third-generation imageRUNNER ADVANCE, imageRUNNER ADVANCE DX, and imagePRESS Lite models. Subscription to a third-party cloud service required. Subject to third-party cloud service providers' terms and conditions. Canon and imageRUNNER are registered trademarks of Canon Inc. in Canada and may also be registered trademarks or trademarks in other countries. All other referenced product names and marks are trademarks of their respective owners. Specifications and availability subject to change without notice. Not responsible for typographical errors. Neither Canon Inc. nor Canon Canada Inc. represent or warrant any third-party product or feature referenced hereunder.

©2023 Canon Canada Inc. All rights reserved.

Canon

canon.ca

